

# SIMULTANEOUS EJECTION BLOCKING

## ELECTRICAL / MECHANICAL

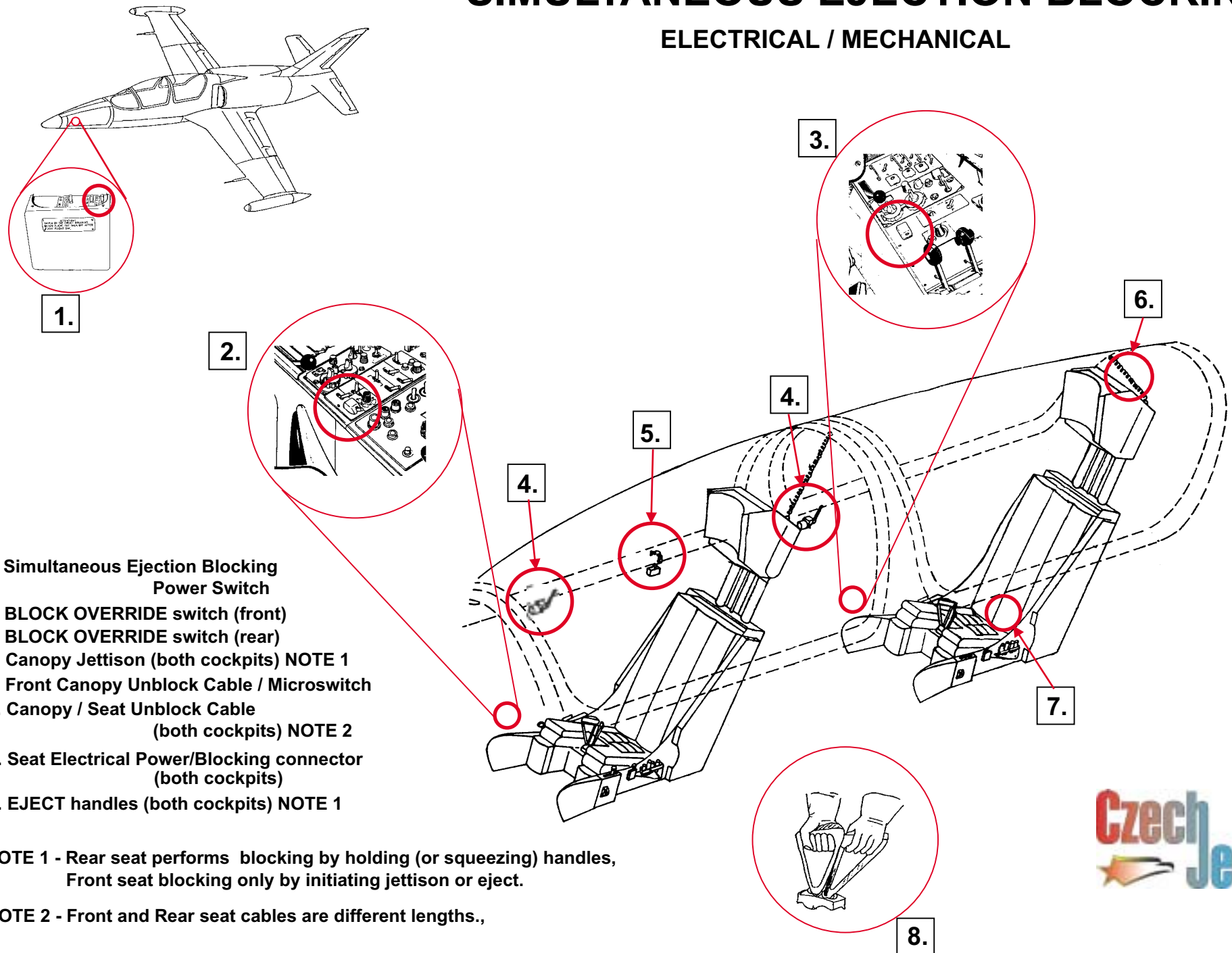

1. Simultaneous Ejection Blocking Power Switch
2. BLOCK OVERRIDE switch (front)
3. BLOCK OVERRIDE switch (rear)
4. Canopy Jettison (both cockpits) NOTE 1
5. Front Canopy Unblock Cable / Microswitch
6. Canopy / Seat Unblock Cable (both cockpits) NOTE 2
7. Seat Electrical Power/Blocking connector (both cockpits)
8. EJECT handles (both cockpits) NOTE 1

NOTE 1 - Rear seat performs blocking by holding (or squeezing) handles, Front seat blocking only by initiating jettison or eject.

NOTE 2 - Front and Rear seat cables are different lengths.,